



**TUSCOLA COUNTY DRAIN COMMISSIONER**

**Robert Mantey**  
125 W. Lincoln Street  
Caro, Michigan 48723

**LAZELLE 1927 DRAIN**

**NOTICE OF DAY OF REVIEW OF DRAINAGE DISTRICT BOUNDARIES  
AND REVIEW OF APPORTIONMENTS**

**DATE:** **Wednesday, May 22, 2019**

**TIME:** **9:00 a.m. – 5:00 p.m.**

**LOCATION:** **Tuscola County Drain Commissioner's Office  
Purdy Building, Suite 100  
125 W. Lincoln Street  
Caro, Michigan 48723**

**QUESTIONS:** **(989) 726-0286**

The Day of Review is an opportunity to review the Lazelle 1927 Drain Drainage District boundaries and apportionment of benefit with the Drain Commissioner or a staff member. A map of the proposed Drainage District boundary revisions can be found on the reverse side of this notice and on the Drain Commissioner's website at: <https://www.tuscolacounty.org/drain/>.

The Drain Commissioner, engineers and/or other staff members will be available to assist individuals throughout the day and make revisions where necessary. There is no need to schedule an appointment for a specific time on the Day of Review. The computation of costs for the Drain will also be available at the Day of Review. Drain assessments are collected in the same manner as property taxes and will appear on your winter tax bill. If drain assessments are being collected for more than one (1) year, you may pay the assessment in full with any interest to date at any time and avoid further interest charges.

Persons with disabilities needing accommodations for effective participation in the Day of Review should contact the Drain Commissioner's Office at the number noted above (voice) or through the Michigan Relay Center at 7-1-1 (TDD) at least 24 hours in advance of the Day of Review to request mobility, visual, hearing or other assistance.

You may appeal the Drain Commissioner's decision to revise the district boundary to the Tuscola County Circuit Court within ten (10) days, and you may also appeal the determination of apportionments to the Tuscola County Probate Court within ten (10) days.



# EXHIBIT "B1"

## LAZELLE 1927 DRAIN DRAINAGE DISTRICT

TUSCOLA COUNTY DRAIN COMMISSIONER - ROBERT J. MANTEY

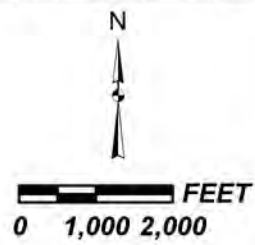
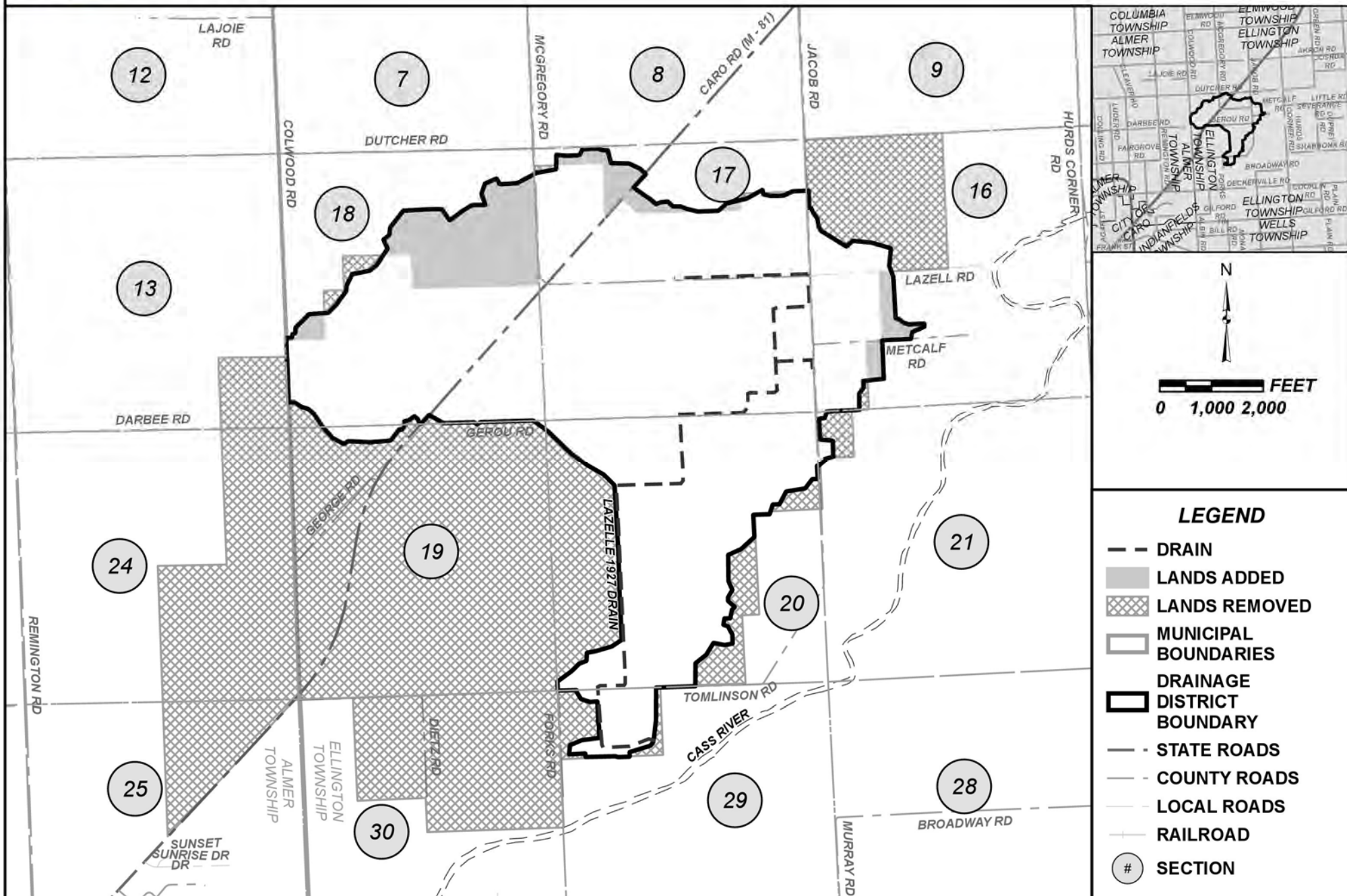

**LEGEND**

- DRAIN
- LANDS ADDED
- LANDS REMOVED
- MUNICIPAL BOUNDARIES
- DRAINAGE DISTRICT BOUNDARY
- STATE ROADS
- COUNTY ROADS
- LOCAL ROADS
- RAILROAD
- # SECTION