

STATE OF MICHIGAN
DEPARTMENT OF AGRICULTURE
AND RURAL DEVELOPMENT
Environmental Stewardship Division

In the Matter of: Clark Intercounty Drain

NOTICE OF DAY OF REVIEW OF DRAINAGE DISTRICT BOUNDARIES
AND DAY OF REVIEW OF APPORTIONMENTS
(In accordance with 1956 PA 40, as amended)

Notice is Hereby Given that on the following dates and at the following locations, the Sanilac County Drain Commissioner and the Tuscola County Drain Commissioner will hold a Day of Review of Drainage District Boundaries and a Day of Review of Apportionments from 9 a.m. to 5 p.m.:

Sanilac County Drain Commissioner
Wednesday, August 2, 2017
60 West Sanilac Avenue, Suite 201
Sandusky, Michigan 48471

Tuscola County Drain Commissioner
Wednesday, September 6, 2017
125 West Lincoln Street, Suite 100
Caro, Michigan 48723

At those times and places, the Drain Commissioners will hear the proofs and allegations and carefully reconsider and review the description of lands comprising the Drainage District for the Clark Intercounty Drain, and determine whether the addition or deletion of lands will more accurately define the boundaries of the land benefitted by the Drain and is just and equitable pursuant to Section 197 of 1956 PA 40, as amended. The Drain Commissioners will also review the apportionment of benefits for assessment purposes. The Drain is located and established in the following municipalities, and a general description by section number of the lands proposed to be added or deleted in whole or in part include the following:

Sanilac County, Evergreen Township – Sections 18, 19, 20, 29, 30 and 32
Tuscola County, Novesta Township – Section 24

The Drain Commissioners will have the tentative apportionments against parcels and municipalities within the Drainage District available to review. Drain assessments will be collected in the same manner as property taxes. If Drain assessments are to be collected in installments, they may be paid in full with any interest to date at any time to avoid further interest charges. A map of the proposed Drainage District boundary revisions may be found at the County Drain Commissioner’s Offices or their web sites (www.SanilacCounty.net and www.TuscolaCounty.org).

The entities to be assessed at large are as follows: Evergreen Township, Novesta Township, Sanilac County, Tuscola County, and the Michigan Department of Transportation. A description of the land constituting the special assessment district for the Clark Intercounty Drain, as currently existing and as proposed, is as follows:

SANILAC COUNTY			
090-018-300-020-00	090-019-300-020-01	090-030-100-010-00	090-030-200-010-01
090-018-300-060-00	090-019-300-030-00	090-030-100-020-00	090-030-200-020-00
090-018-300-070-00	090-019-400-010-00	090-030-100-030-00	090-030-400-010-10
090-018-300-080-00	090-019-400-010-01	090-030-100-040-00	090-030-400-010-20
090-018-400-010-00	090-020-300-010-00	090-030-100-050-00	090-030-400-015-00
090-018-400-020-00	090-020-300-020-00	090-030-100-060-00	090-030-400-015-01
090-018-400-030-00	090-020-300-040-00	090-030-100-070-00	090-030-400-020-00
090-019-100-010-01	090-029-100-040-01	090-030-100-070-01	090-030-400-020-02
090-019-100-030-00	090-029-200-010-00	090-030-100-070-02	090-030-400-030-00
090-019-200-010-00	090-029-200-015-00	090-030-100-070-03	090-032-200-010-00
090-019-200-010-01	090-029-200-020-00	090-030-100-080-00	
090-019-300-010-00	090-029-200-030-00	090-030-100-090-00	
090-019-300-020-00	090-029-300-010-00	090-030-200-010-00	
TUSCOLA COUNTY			
018-024-000-0100-01	018-024-000-0300-00	018-024-000-1200-02	018-024-000-1300-04
018-024-000-0100-02	018-024-000-0900-00	018-024-000-1200-03	018-024-000-1500-05
018-024-000-0200-00	018-024-000-1000-01	018-024-000-1200-04	

Persons with disabilities needing accommodations for effective participation in the meeting should contact the Sanilac County Drain Commissioner at (810) 648-4900, the Tuscola County Drain Commissioner at (989) 672-3820, or the Michigan Relay Center at 711 (TTY) at least 24 hours in advance of the meeting to request mobility, visual, hearing, or other assistance.

You are Further Notified that persons aggrieved by the decision of the Clark Intercounty Drain Drainage Board to add or delete property to or from the Clark Intercounty Drain Drainage District may seek judicial review in their respective County Circuit Court within ten (10) days of the decision. And persons aggrieved by the decision of the Drain Commissioners with regard to the apportionment of benefits for assessment purposes may appeal to their respective County Probate Court within ten (10) days of the Day of Review.

July 12, 2017

Greg Alexander
Sanilac County Drain Commissioner

Robert J. Mantey
Tuscola County Drain Commissioner

Jamie Clover Adams
Director of Agriculture and Rural Development
By: Brady Harrington, P.E., Deputy for the Director
P.O. Box 30017
Lansing, Michigan 48909
(517) 284-5623

CLARK INTERCOUNTY DRAIN DRAINAGE DISTRICT

TUSCOLA AND SANILAC COUNTY DRAIN COMMISSIONERS

ROBERT J. MANTEY AND GREG ALEXANDER

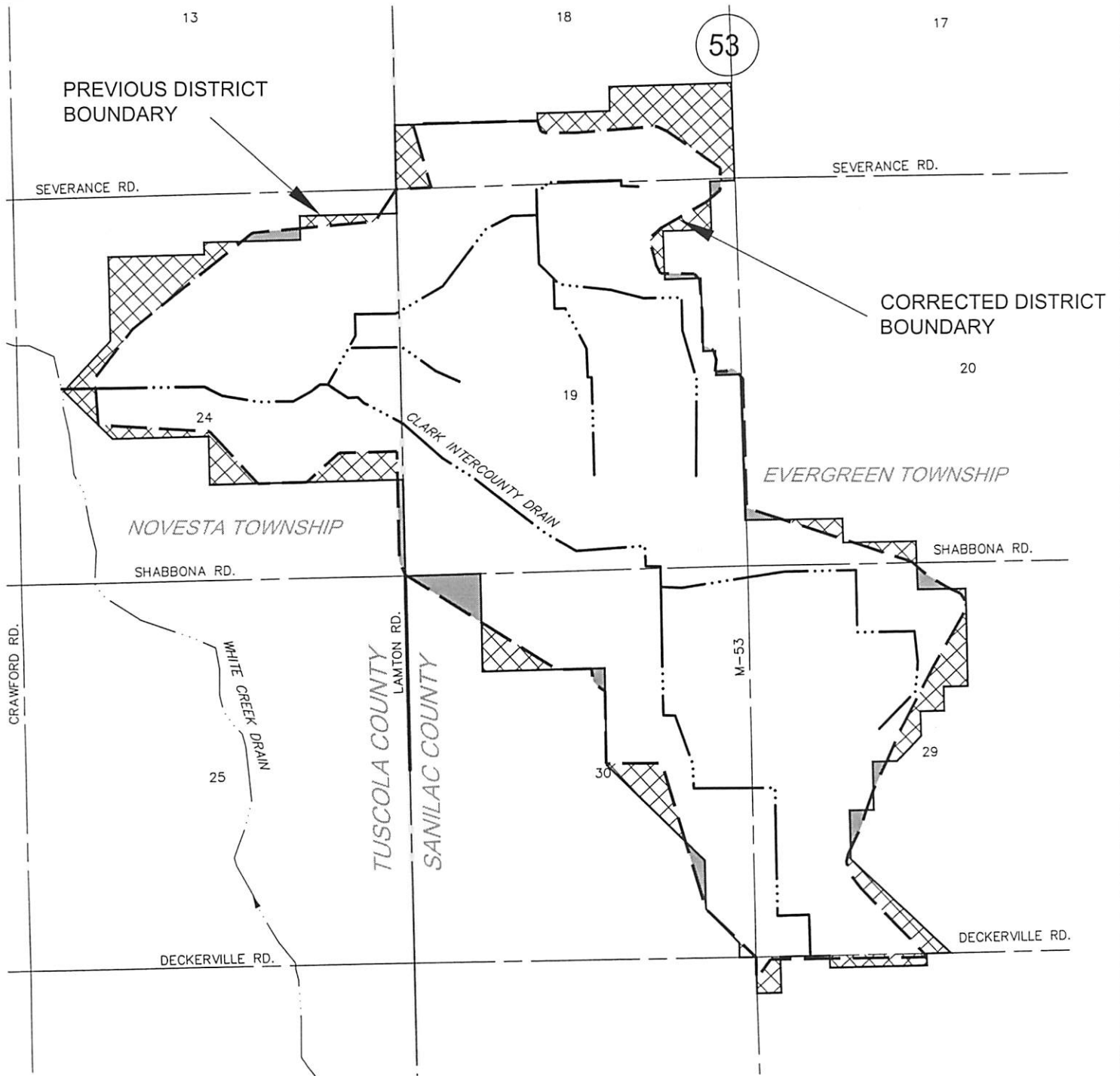

COUNTY KEY

LEGEND

	DRAINAGE DISTRICT BOUNDARY
	LANDS PROPOSED TO BE ADDED
	LANDS PROPOSED TO BE REMOVED
	DRAIN
	MUNICIPAL BOUNDARIES
	COUNTY BOUNDARIES
	ROADS



FAQs

Robert J. Mantey
Tuscola County
Drain Commissioner



FREQUENTLY ASKED QUESTIONS about the Day of Review of Drainage District Boundaries and Review of Apportionments

What is a Day of Review of District Boundaries?

The Michigan Legislature passed a law in 2013 to allow revisions to historical drainage district boundaries when recommended by a licensed engineer.

Property owners can review changes with the Drain Office staff during the Day of Review. The proposed boundary revisions can be found on the map on the reverse side of the notice and in more detail at the Tuscola County website at: www.tuscolacounty.org.

What is a Drainage District?

A drainage district is the land area that benefits from the drain. The drainage district makes up the watershed that contributes water to the drain. Each property and municipality within the drainage district pays for maintenance and improvement of the drain.

Why are the boundaries being revised?

Revisions are recommended because the historic drainage district boundaries do not accurately reflect the current watershed of the drain.

What is a Day of Review of Apportionments?

A Day of Review of Apportionments provides an opportunity for property owners to review the percent of benefit of the drain assigned to their property. The apportionments of benefit are based on acreage, land use, and other factors. The apportionments determine the assessment amount for each property for costs of construction or maintenance.

Why are the apportionments being revised?

Parcel apportionments are being revised to more accurately reflect the percentage of benefit that each property receives from the drain.

If a parcel is on the outer boundary of a drainage

district, it is possible that only a portion of the parcel will be assessed.

Why did I receive a notice?

Notices went out to the following property owners:

- ***Properties being added to the Drainage District.*** The properties were not previously in the drainage district, but the engineers determined that the properties are within the drain's watershed.
- ***Properties being removed from the Drainage District.*** The properties were previously in the drainage district, but the engineers determined that the properties are not in the drain's watershed.
- ***Properties currently in the Drainage District and proposed to remain in the Drainage District.*** There is no change in terms of boundaries for these properties.

All property owners subject to an assessment were sent a copy of the notice.

When do I receive my drain assessment?

Drain assessments are included on your Winter Tax bill, and are only levied when costs are incurred for the drain. Assessment amounts vary from year to year.

What is my assessment amount?

Estimated assessment amounts are available at the Day of Review. If you are unable to attend, you may call (989) 863-4015 if you have any questions.

Do I have to attend the Day of Review?

You are not required to attend the Day of Review.

How can I get more information?

Visit our website at www.tuscolacounty.org or call (989) 863-4015.

Robert J. Mantey

Tuscola County Drain Commissioner | 125 W. Lincoln St. Ste. 100 | Caro, MI 48723 | (989) 863-4015 | tuscolacounty.org